



CLEMCO

The Performance System

TECHNICAL DATA SHEET

Note: For safe, efficient blasting, read and follow the owner's manual and seek training for everyone who will use this equipment.

Purpose

The Apollo 600 LP is designed for use with an ambient air pump. It meets OSHA standards for respiratory protection and air noise limitations. The Apollo 600's

full-helmet design protects the blast operator's head from rebounding abrasive and from job-site impact hazards.

The heavy-duty silver-grey cape protects the operator's neck, shoulders, and chest from rebounding abrasive.

Requirements for Operation

The following items are required or recommended for operation, but may not be included with this respirator:

- An ambient air pump capable of delivering 7 to 15 cfm of air at 8 to 12 psi
- Output from the ambient air pump must meet the standard for Grade D breathing air, as defined by the Compressed Gas Association, Commodity Specification: G-7.1 (www.cganet.com)
- Approved 1/2-inch ID x 50 or 100 feet long respirator hose from the ambient air pump to the helmet connection
- Protective clothing, gloves, and shoes suitable for a heavy construction site
- Primary hearing and eye protection

Description of Operation

The Apollo 600 includes a knob-adjustable suspension. The operator fits the helmet to his or her head by turning the suspension knob clockwise to enlarge and counter-clockwise to decrease size. The suspension fits head sizes 6.5 to 8. The adjustable chin strap holds the helmet in position on the operator's head.

The wide, full-view window provides an expansive field of vision. A series of lenses preserves the operator's clear view of the work surface and protects the operator from dust and abrasive in the

Description

The Apollo 600 LP is a type CE, continuous-flow, supplied-air respirator as defined by the National Institute for Occupational Safety and Health (NIOSH) for abrasive blasting to be used with an ambient air pump.



surrounding air. A replaceable fixed inner lens securely fits inside a molded rubber gasket. An intermediate lens protects the inner lens; and up to 3 tear-away (perforated) outer lenses complete the system. The tear-away lenses are removed one at a time to expose a clean lens beneath. The multi-lens system is held in place by a hinged frame with replaceable latch.

The Apollo 600 LP comes with a Constant-Flow Connector (CFC) that provides a fixed flow of air. It is engineered for flow settings as specified by OSHA.

A flexible breathing tube maintains air flow between the inlet fitting on the operator's belt and a replaceable inlet fitting at the center rear of the helmet crown for maximum operator comfort and maneuverability. The tube contains specially-formulated sound-deadening materials to reduce noise levels of incoming air to 80 dBA.

The helmet is generously sized to allow ear plugs or ear muffs and safety glasses or goggles as needed.

Incoming air enters the system through the air control device on the operator's belt. It continues through the breathing-air tube to enter the helmet at the inlet fitting at the center rear of the helmet crown. An air-distribution channel guides air over the head to the operator's face.

Apollo 600 LP Supplied-Air Respirators

for use with ambient-air pump
Stock Nos. 24010-24011

Advantages

- Expansive, 180° full-view window
- Multi-lens system with rugged, positive-latching window frame
- Built-in mini visor prevents media ingress between lenses
- User-friendly cape attachment system
- Zip-in-and-out washable inner collar
- Replaceable inlet fitting
- Replaceable window latch
- Generous interior dimension allows supplementary hearing and eye protection
- Optional rectangular lens

Approvals and Certifications

The Apollo 600 LP helmet is a NIOSH-approved type CE respirator (approval number TC# 19C - 358) and is recognized by OSHA as having an assigned protection factor (APF) for lead dust of 1000 times the permissible exposure limit (PEL) for lead dust. It also meets the American National Standards Institute (ANSI) requirement for industrial head protection as stated in ANSI 289.1-2003 as a Type I, Class G protective helmet.

NOTE: Prior to use, ensure that the Apollo, type CE, supplied-air respirator is appropriate for your specific blasting conditions and requirements.

Respirator Systems and Accessories

Description	Stock No.
Apollo 600 LP, less respirator hose, with constant flow connector	24010
Apollo 600 LP, with 50 ft. respirator hose, and constant flow connector.....	24011

Options and Accessories

Blast suit, heavy cotton/leather S (08920), M (08921), L (08922), XL (08923) XXL (24201), XXXL (24202)	
Blast suit, seasonal cotton/nylon M (22914), L (22915), XL (22916), XXL (22917)	
Leather gloves	02243
High pressure conversion kit Converts LP helmet to HP helmet	24811
Noise reduction ear muffs	23886
Clemco Do-rag	23814
Ambient Air Pump, Single-operator, CAP-1.....	22383
Four-operator, Stationary, CAP-4	22530
Four-operator, Portable, CAP-4C	22384
Rectangular outer lens, .015", non-perf., (pk of 25).....	24005

Related Clemco Literature

Description	Stock No.
Contractor Series Catalog	21385
Abrasive Blasting Safety Practices	22090
Blast Off 2	09294
Safety Equipment Product Study	07764
Apollo 600 LP Owner's Manual	23929

Shipping Dimensions and Weights

Respirator

Stock No.	Dimensions	Weight
24010	13-1/2" x 13" x 12"	7.5 lb
24011	13-1/2" x 13" x 12"	18.5 lb

Respirator Hose (in separate poly bag)

Stock No.	Dimensions	Weight
22510	1/2" x 50 ft. (18" x 18" x 4")	11 lb
21413	1/2" x 100 ft. (18" x 18" x 6")	22 lb

Replacement Parts

Item	Description	Stock No.
1.	Constant-flow connector without belt	21429
2.	Belt assembly, 2"	04430
3.	Respirator hose, 1/2" x 50' (standard)	22510
4.	Respirator hose, 1/2" x 100' (optional)	21413
5.	Acoustical foam kit	04369
6.	Gasket, window	23819
7.	Inner lens, .040" (pk of 5)	04367
8.	Intermediate lens, .020" (pk of 5)	24943
	(pk of 25)	04373
9.	Outer lens, .0075", perforated (pk of 25)	04361
10.	Window frame assembly	24012
11.	Chin strap.....	04460
12.	Handle strap.....	03623
13.	Suspension	23802
14.	Suspension sweatband	23817
15.	Clips, suspension, (pk of 4).....	24773
16.	Cape attachment band	23801
17.	Cape, silver-grey, with red inner collar	23818
18.	Breathing tube w/swivel ends	22811
19.	O-ring, 11/16" ID x 7/8" OD, (2 required)	22815
20.	Inner collar	08740
21.	Window latch kit, incl: base and screws	24006
22.	Inlet fitting	23804
23.	Chin strap holder kit (2 with fasteners)	24008
24.	Partition air baffle	23811

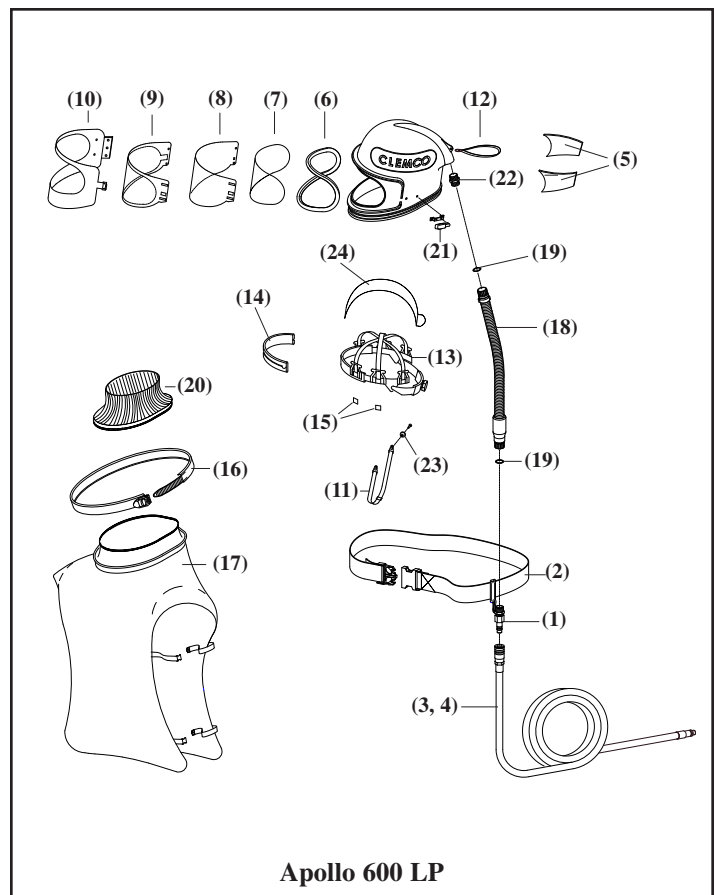

Authorized Distributor:

ISO 9001-2000 certified. Clemco is committed to continuous product improvement. Specifications are subject to change without notice.

© 2007 Clemco Industries Corp. • One Cable Car Drive • Washington, MO 63090 • Phone (636) 239-4300 • Fax (800) 726-7559

Stock No. 24183

www.clemcoindustries.com

Job No. 1195-1295 • Rev. B 06/07